

Cathode Lighting Systems Inc.
8020 Queenair Drive
Gaithersburg, MD 20879
Ph: (800) 551-5012
Fax: (301) 963-3050
Email: Info@CathodeLightingSystems.com

INDEX

- Page 1: Section A: Preparing the luminaire for installation
- Page 2: Section B: Attaching conduit and wiring the luminaire
- Page 3: Section C: Installing more than one luminaire end to end
Section D: Mounting the luminaire
- Page 4: Section E: Installing lamps
Section F: Removing lamps
Section G: Troubleshooting

SECTION A: PREPARING THE LUMINAIRE FOR WIRING

Please read these instructions carefully before installing this luminaire. You will notice that this luminaire looks different from other fluorescent luminaires, however, it has been designed for easy installation and has been preassembled and tested at the factory.

All luminaires are furnished with dimmable electronic ballasts. Ballasts are dimmable using a 3-wire fluorescent dimmer. Lutron is preferred. Primary wiring for these luminaires must contain three (3) conductors, plus a ground wire.

INSTALLATION OF THIS LUMINAIRE MUST BE PERFORMED BY A LICENSED ELECTRICIAN. ALL INSTALLATION AND WIRING METHODS MUST COMPLY WITH THE NATIONAL ELECTRIC CODE AND ALL APPLICABLE LOCAL CODES.

Step #1: Remove luminaire(s) from packaging container.

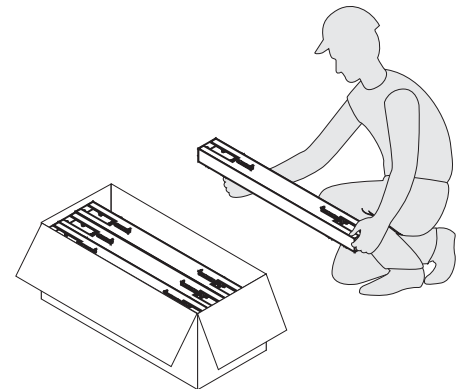

Step #2: Remove the snap-in cover.

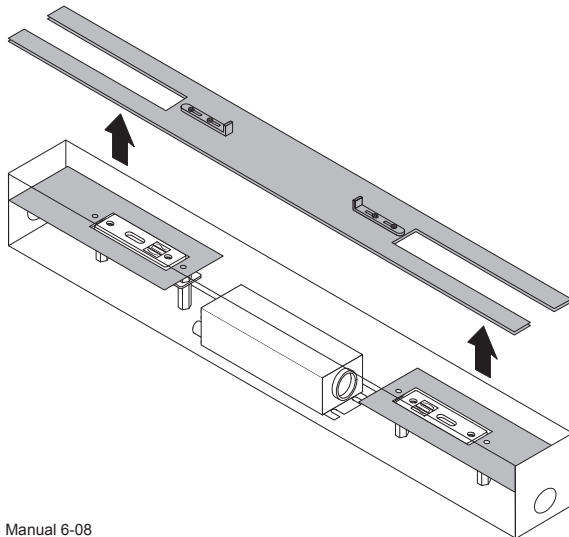

Step #3: Remove the covers of the wiring compartments at the ends of the luminaire. Please save the screws for reinstallation after wiring is complete.

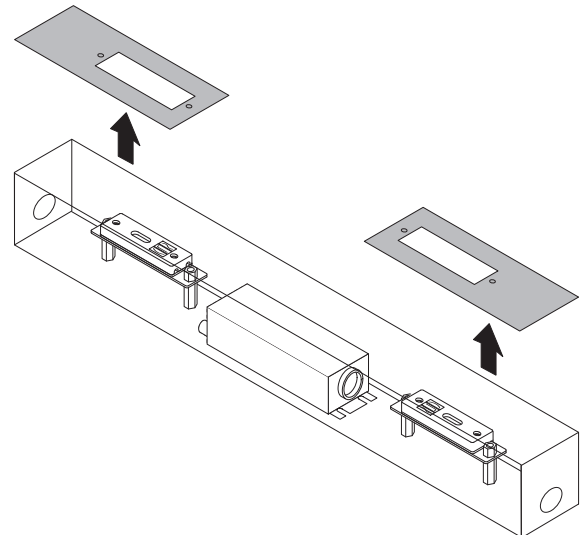

SECTION B: ATTACHING CONDUIT CONNECTOR AND WIRING THE LUMINAIRE

IMPORTANT: CIRCUITS MUST BE DE-ENERGIZED WHEN PERFORMING ANY WIRING / INSTALLATION OPERATION.

Step #1: Using a flathead screw driver, remove the knockout at the end of the luminaire. Knockouts are 1/2" trade size (7/8" O.D.).

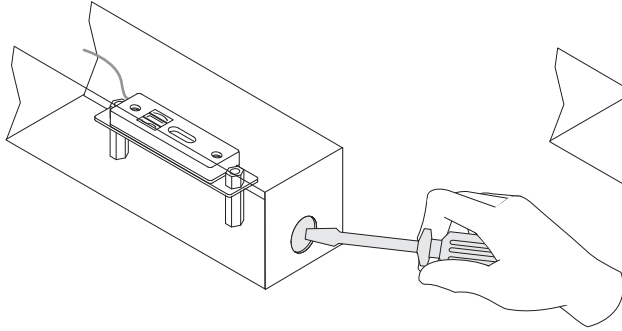

Step #2: Install 1/2" MC Connector

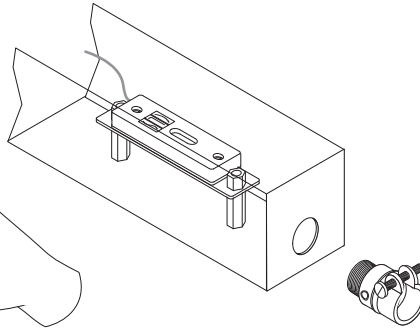

Step #3: Attach 1/2" MC cable (3 wire + ground) to the luminaire, and proceed with primary wiring.

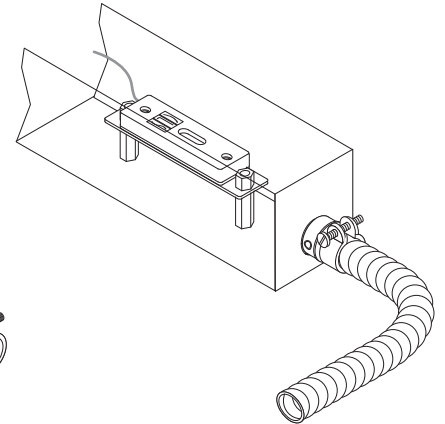

Step #4: Complete primary wiring connections.

LUMINAIRE WIRING DIAGRAM

DIMMING: Luminaires are dimmable utilizing 3-wire fluorescent dimmers. Lutron is preferred.



PLEASE NOTE: If luminaire is only to be switched on and off, and not dimmed, the red and black ballast leads must be wired together, and then to the switched, hot primary circuit.

Red (dimmed hot)
Black (switched hot)
White (neutral)
Green/Yellow (ground)

(Note: All luminaires must be properly grounded)

Step #5: Replace wiring compartment covers.

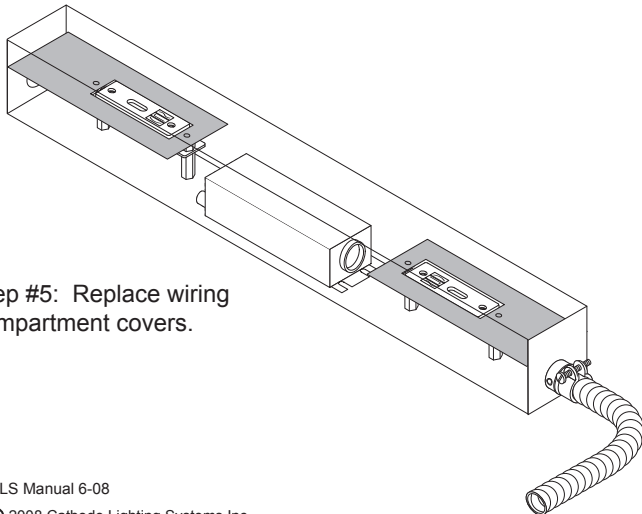

Step #6: Replace snap top.

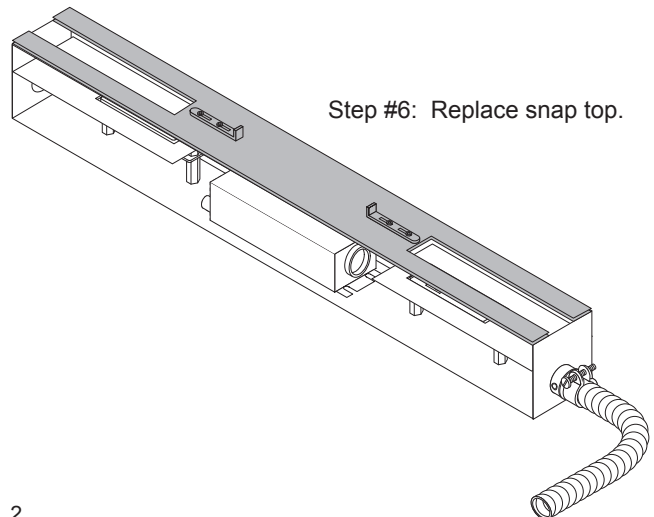

SECTION C: INSTALLING MORE THAN ONE LUMINAIRE END TO END

Step #1: Remove knockouts at each end (refer to section B, step 1), and align luminaires.

Remove wiring compartment covers (refer to section A, step #3).

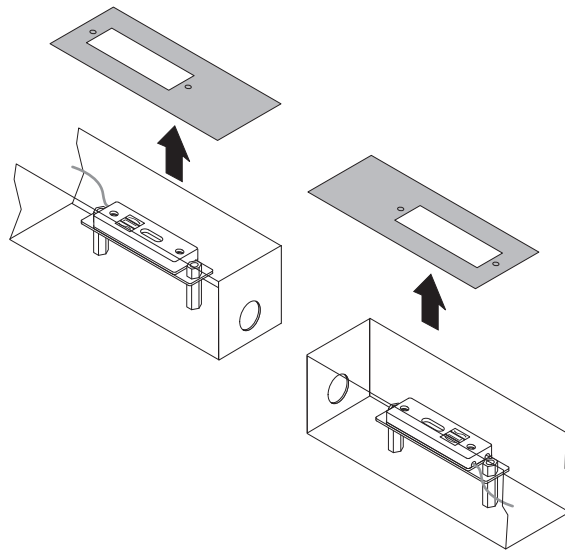

Step #2: Using a UL-Listed 1/2" conduit nipple and locknut, attach the adjoining luminaires and tighten until snug.

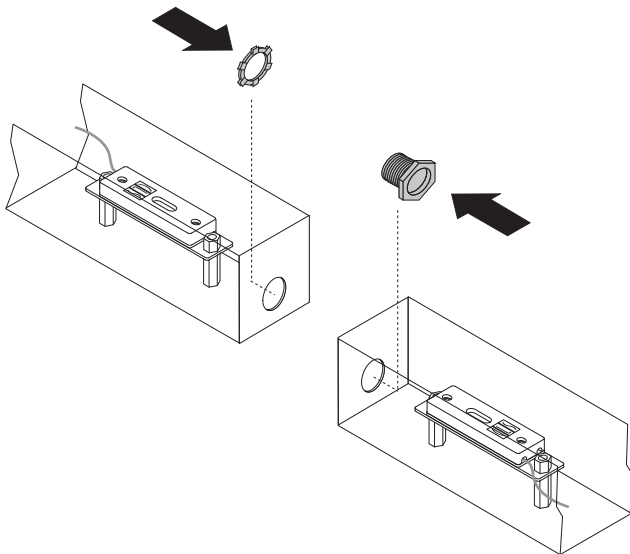

Step #3: Replace wiring compartment covers.

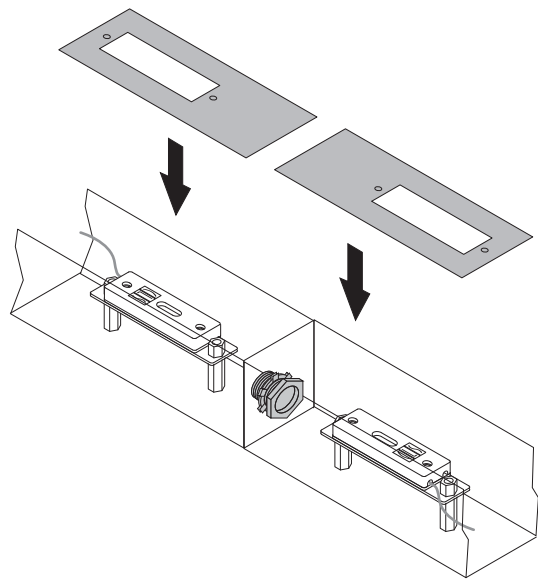

SECTION D: MOUNTING THE LUMINAIRE

Using the appropriate fasteners, and the groove in the interior bottom of the luminaire as a guideline, fasten the luminaire securely to the mounting surface. Fasteners and fastening methods must be selected so that each fastener is capable of supporting the entire weight of the luminaire. Self-drilling screws may be used, or a hole may pre-drilled for use with the proper fastener.

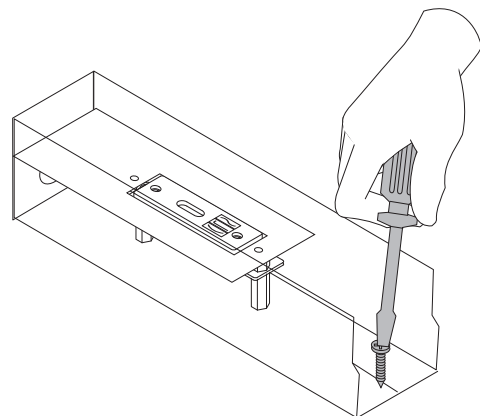

SECTION E: INSTALLING LAMPS

PLEASE NOTE: The lamps and ballasts used in this luminaire are unique and are not interchangeable with any other manufacturer's lamps or ballasts. Do not attempt to install any other lamp or ballast in this luminaire.

STEP #1: Carefully insert lamp into the lampholders. Make sure each lamp end is making secure electrical contact with the lampholders.

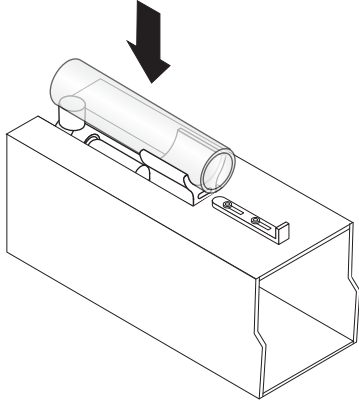

STEP #2: Using a flathead screwdriver, gently slide the "lamp-lock" clips into the lock position. If clip does not slide completely forward into the lamp base, the lamp may not be properly inserted into the lampholders.

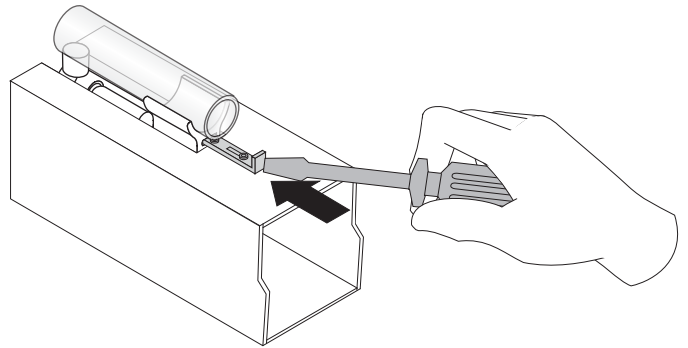

SECTION F: REMOVING LAMPS

STEP #1: Using a flat head screwdriver, gently slide the "lamp-lock" clips into the unlocked position.

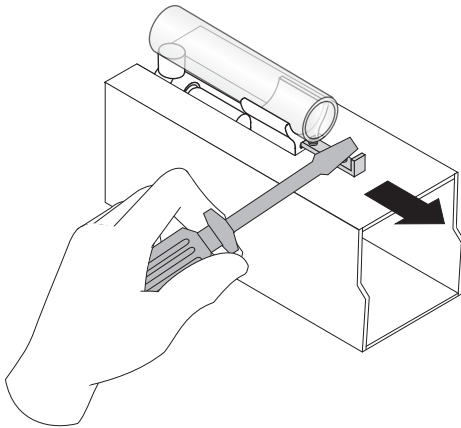

STEP #2: Carefully remove the lamp.

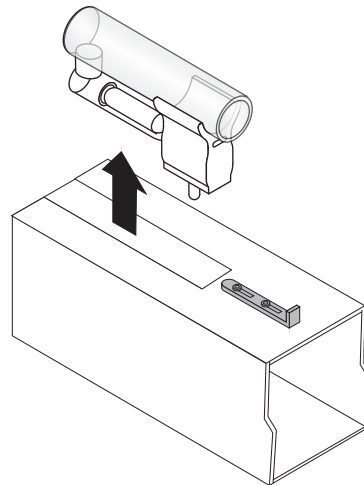

SECTION G: TROUBLESHOOTING

Luminaire will not light.

The ballast in this luminaire is equipped with integral open-circuit and ground-fault protection. If the luminaire is energized without a lamp in place, the ballast will turn itself off automatically. To reset the ballast, the primary power must be turned off, and then on again. If the luminaire still does not light, the lamp could be inoperable. Contact the factory for further assistance.

Lamp exhibits a rolling or spiraling effect

Turn the luminaire off for five seconds, and then turn off for two seconds. Repeat this procedure 5-10 times. The rolling or spiraling should stop. If the lamp continues to roll or spiral, remove the lamp from the luminaire, wipe it with a clean rag, and reinsert the lamp 180 degrees from its previous orientation. If the lamp continues to appear unstable, contact the factory for further assistance.

Cathode Lighting Systems Inc.
8020 Queenair Drive
Gaithersburg, MD 20879
Phone: 800-551-5012
Fax: 301-963-3050
Email: Info@CathodeLightingSystems.com